

### Registration Desk

The registration desk will locate in the lobby near Gate C3 of CNCC from Oct. 26 until the morning of Oct. 29, 2018. The registration desk will be open during the following days and times:

Oct. 26 (Lobby of CNCC): 9:00-22:00

Oct. 27-Oct. 29 (Lobby of CNCC): 8:30-12:00, 13:30-17:00

### Oral Sessions

Please bring your slide copy to the PPT Collection Room (near Gate C3, 1st Floor) and run a test the day before your presentation. Please treat all scientific presentations and abstracts in abstract book as confidential unpublished research. Abstracts should not be cited. If you want to cite results, please do so as a “personal communication” only with agreement from the respective authors. In addition, slides should not be photographed. Results presented at this conference may not be used as the basis of research without the explicit permission of the corresponding author.

### Poster View

Poster session will be held in Plenary Hall B of the 4th floor from 18:30 to 20:00 on Oct.27 and Oct.28.

### Exhibition

A scientific exhibition and poster session will be held during the conference to highlight recent developments in technology and to demonstrate new products for biophysics research and related fields. The exhibition will be held in Plenary Hall B of the 4th floor and will be open at 8:30-18:00 from Oct. 27-Oct. 28 and 8:30-16:00 on Oct.29.

### Welcome Reception

Welcome Reception is free for all WLSC2018 registered participants. Drinks and light snacks will be served. Please join us in the Ballroom at 1st floor from 18:00 to 20:00 on Oct. 26.

### Working Lunch

Lunch tickets will be given to you after registration. There will be a ticket for each day and you will need to hand this over to the catering staff. Please find the location of lunch on the meal coupons.

### Name Badge

Your name badge provides identification for your admission to the scientific sessions as well as to the coffee breaks and exhibitions. Please wear it at all times in CNCC.

## GENERAL INFORMATION



### Volunteer

There are volunteers in each meeting room to assist all WLSC2018 participants. They can be easily identified by wearing the orange vest with conference logo. If you have any difficulties or questions, feel free to reach them directly.

### Internet Access

Free Wireless Internet access will be available for WLSC2018 participants in CNCC. Please connect to “CNCC FREE”.

### International Calls

Dial 00 + country code + area code + phone number.

### Electricity

The electric current in China is 220V. Most hotels have built-in converters in bathrooms for shavers and hair dryers. Please note that a variety of plug types are used in China, and adaptors may be necessary. Two types of sockets are used in China: three-pin socket (a grounding pin and two flat prongs forming a V-shape) and two-pin socket (two flat parallel prongs without grounding).



### Insurance

The registration fee does not include insurance. The conference organizers do not accept any liability for personal accidents or loss or damage to the private property of any participants during the conference or indirectly arising from attending the conference. It is advisable that participants should take adequate travel and health insurances before leaving your own countries.

### First Aid and Medical Service

The telephone number for the first aid is 120 or 999. Several hospitals in Beijing are staffed with English speaking doctors. 2.5km away from CNCC is the China-Japan Friendship Hospital, where participants may receive first-aid medical treatment if necessary.

### Weather

Beijing enjoys a typical continental, yet affable monsoon climate. It has distinctive four seasons, the brief blooming spring, the long hot summer, the golden fruitful autumn and the brisk harsh winter. December in Beijing is sunny and much cooler. The average daily temperature is about 22°C (71.6°F), with the high at around 25°C (77°F) and low at 8°C (46.4°F).

### Currency Exchange



Renminbi (RMB) is the only used currency in China. Exchange centers can be found at airports, most hotels and large shopping centers. The exchange rate is due to the official rate (Bank of China). When exchanging money, please keep your receipt by which you can change any remaining RMB back to foreign currency when leaving China. Visa, Master, American Express, Discovery card are accepted in many department stores and hotels. You may withdraw RMB from your debit card at ATM, but it may be difficult to draw cash with credit cards. The Bank of China and most hotels can cash travelers' cheque issued by any foreign bank or financial institution. Participants will need to show a passport and pay a 0.75 percent commission.



### Shopping

Most stores are opened during 10:00-21:00 every day. The nearest shopping mall beside CNCC is Xin'ao Shopping Center.

### Personal Safety

Make sure to put your passport and valuables in a safe place. Be aware of pickpockets in the crowds. In case of loss of passport, contact the local police and the embassy of your country immediately.

### Transportation (From Beijing Capital International Airport to CNCC)

#### By Subway

Take the Airport Express Line runs from Terminal 3 or Terminal 2 to Sanyuanqiao Station (三元桥站), then transfer to Line 10 to Beitucheng Station (北土城站), and then transfer to Line 8 to the Olympic Sports Center Station (奥林匹克公园站).

#### By Airport Shuttle Bus

The airport shuttle bus runs every 30 minutes with different routes from 05:30 to 22:00, including Asian Games Village (Anhui Bridge Station is close to CNCC). The fare is RMB25.

#### By Taxi

Taxi service is available at all terminals of Beijing Capital International Airport. Please be

## GENERAL INFORMATION

---

advised that you should not accept a taxi service offered anywhere other than at the official taxi stand at the airport. The total cost is around RMB100 enclosed the extra highway fee. Please show the Taxi Direction Note and map below to the taxi driver.

### TAXI NOTE

Please take me to the China National Convention Center (CNCC).  
Thank you!

请送我到 国家会议中心，谢谢！

Address of CNCC: 北京朝阳区天辰东路 7 号 (奥运村)

电话 (Tel): 010-84372008

---

### TAXI NOTE

Please take me to the CNCC Grand Hotel. Thank you!

请送我到 国家会议中心大酒店，谢谢！

Address of CNCC Grand Hotel: 北京朝阳区北辰西路 8 号院 (风林绿洲东)

电话 (Tel): 010-84372008

---

### TAXI NOTE

Please take me to the Inter Continental Beijing  
Beichen. Thank you!

请送我到 北京北辰洲际酒店，谢谢！

Address of ICBB Hotel: 北京 朝阳区 北辰西路 8 号院  
4 号楼

电话 (Tel): 010-84371188

---

### TAXI NOTE

Please take me to the V-Continent Beijing  
Parkview Wuzhou Hotel . Thank you!

请送我到 北京北辰五洲皇冠国际酒店，谢谢！

Address of VCBPW Hotel : 北四环中路 8 号

电话 (Tel): 010-84982288

## Culture Highlights of China and Beijing

### · About China

The People's Republic of China is the third largest country in the world in terms of area and the largest in terms of population. Its total area is 9.6 million square kilometers and its population is 1.3 billion. With a history of several thousand years of civilization, China boasts as one of the most significant cultures in the world. Since the 1980's, thanks to the implementation of China's policy of economic reform and opening to the outside world, the nation's economy has developed with great speed. Significant progress has been made in the areas of transportation, communications, and banking, postal service, and energy resources. China has also made notable achievements in the fields of technology, education, culture, health and athletics.

### · About Beijing

Beijing is the capital of The People's Republic of China, which locate in the northern part of the North China Plain, at 39.6 degrees north latitude and 116.2 degrees east longitude. It covers an area of 16,807.8 square kilometers. With a population of over 13 million, tends one of the greatest cities of the ancient and modern world. Beijing was the capital city of the Liao, Jin, Yuan, Ming and Qing Dynasties. The largest imperial palace of the world, the Forbidden City, is located on the central axis of Beijing city. Together with the Summer Palace - a royal park, the Great Wall, Beijing Royal Quadrangle Courtyard etc, Beijing has 7,300 cultural relics and historical sites, as well as more than 200 scenic spots. It has become a modern international cosmopolitan city. Currently, Beijing is one of the country's four municipalities directly under the supervision of the State Council, China's central government. It is divided into 14 districts and 2 counties: Dongcheng, Xicheng, Chaoyang, Haidian, Fengtai, Shijingshan, Mentougou, Fangshan, Tongzhou, Shunyi, Daxing, Pinggu, Changping and Huairou districts and Miyun and Yanqing counties. Beijing can be said to have the charm of antiquity as well as the spirit of modernity indeed. A lot to see and to do in Beijing. Discover this amazing city.

# GENERAL INFORMATION





### Wangfujing (王府井)

Wangfujing in Beijing is a well-known golden commercial district. Shopping in Wangfujing Street has been listed in many travelers' schedule.



### Olympic Green (奥体公园)

China National Convention Center is in the Olympic Village. You can walk to Bird's Nest (National Stadium) and Water Cube.



### Temple of Heaven (天坛)

First constructed in 1420, it was the place where the emperors of the Ming and Qing dynasties would worship the god of heaven and pray for good harvest.



### The Great Wall of China (长城)

The Great Wall built from Qin Dynasty (~2200 years ago), 8000+km long. 'He who does not reach the Great Wall is not a true man (不到长城非好汉)', as this famous Chinese saying goes, the Great Wall of China, a great engineering marvel, always attracts throngs of adventurous tourists from all over the world.



### Forbidden City (故宫)

The former imperial palace which was the home to twenty-four Chinese emperors over 491 years between 1420 and 1911. The Forbidden City is now known as the Palace Museum and is open to visitors. It has 9,999 rooms - a room being the space between four pillars. The well guarded palace is surrounded by a moat 3,800 metres long and 52 metres wide.



### Summer Palace (颐和园)

It was a royal palace in later Qing Dynasty, only secondary to the Forbidden City. Summer Palace is actually not just a royal palace where once Princess Dowager Cixi and the emperor lived and handled court affairs, accepted laudations and received foreign diplomats. It also epitomizes classical Chinese architecture, in terms of both garden design and construction. It is the largest royal garden in Beijing.

# GENERAL INFORMATION

## Map of Subway



图例：Legend

- 地铁1号线
- 地铁八通线
- 地铁4号线
- 地铁大兴线
- 地铁7号线
- 地铁9号线
- 地铁13号线
- 地铁15号线
- 地铁14号线
- 地铁房山线
- 地铁亦庄线
- 机场线



换乘站

- 地铁1号线
- 地铁八通线
- 地铁4号线
- 地铁大兴线
- 地铁7号线
- 地铁9号线
- 地铁13号线
- 地铁15号线
- 地铁14号线
- 地铁房山线
- 地铁亦庄线
- 机场线

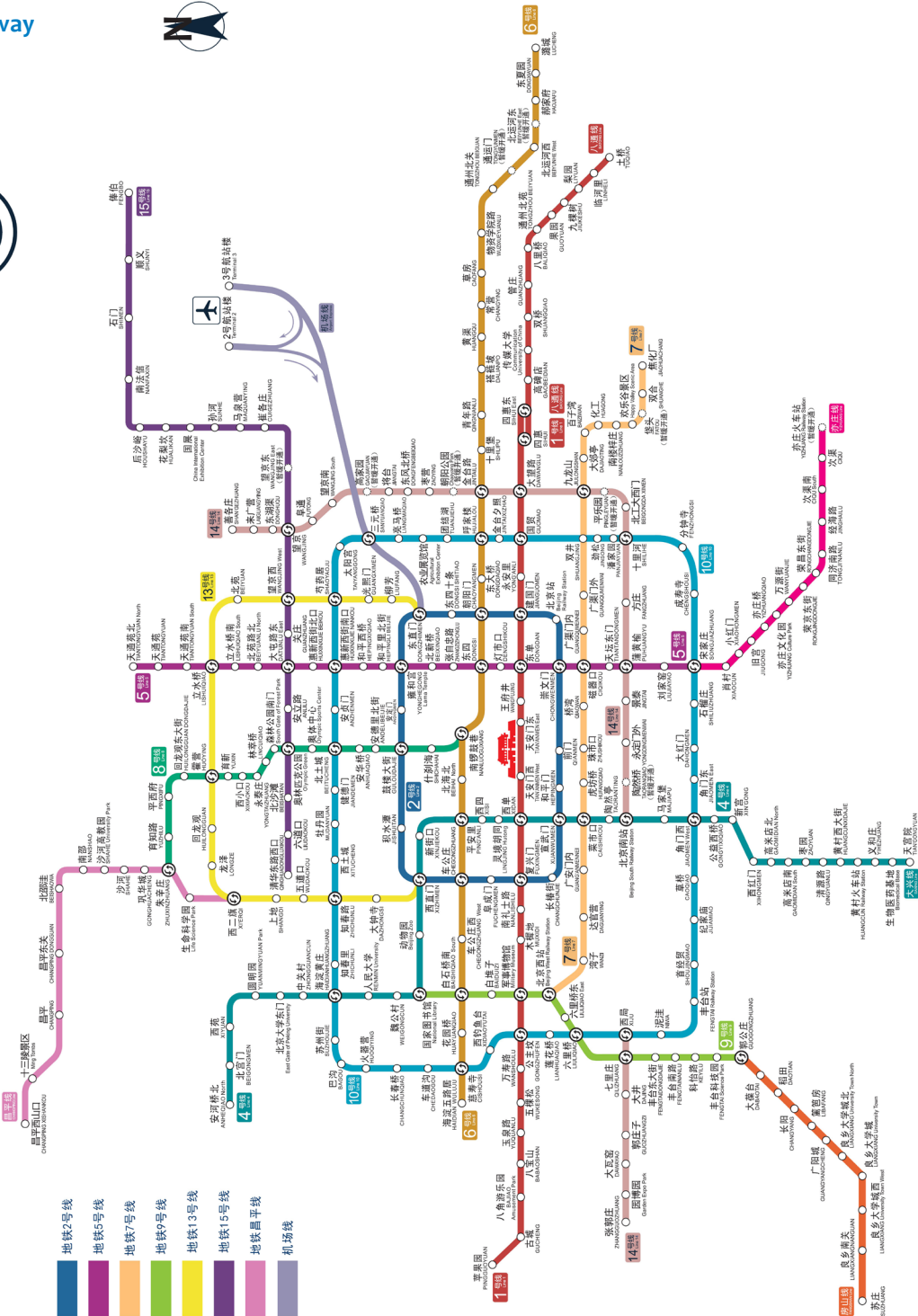



### Dining Routes Reference

· Xin Ao Shopping Center

Route Walk 200 meters straight (the east direction) from the front door of the CNCC, and then go downstairs



## GENERAL INFORMATION

Restaurant	Adress	Characteristic	Per capita consumption	Telephone	Logo
New Yorker	H1-61	American Cafeteria	80-300RMB	010-8437 8485	
Food Court	H1-62	Chinese Fast Food	20-50RMB	010-84374628	
Yoshinoya	H1-63-01	Japanese Food	30-50RMB	010-84371107	
Huatian Yanji Restaurant	H1-59-01	Korean Food	20-50RMB	010-84378265	
Qing-Feng Steamed Dumpling Shop	H1-59-02	Steamed Stuffed Buns	15-50RMB	010-84377200	
Orient King of Dumplings	H1-45-01	Dumplings	30-100RMB	010-84377368	
Subway	H1-49	American Fast Food	20-50RMB	010-84377920	
Element H.k	H1-50-01	Hong Kong Style Tea	50-100RMB	010-84374018	
Xiabu Xiabu	H1-52-01	Hot Pot	50-100RMB	010-84370951	
Yi Wan Ju	H1-53	Peking Noodles	30-100RMB	010-84377373	
Hollywood	H1-54	Fast Food With Varies Styles	20-50RMB	010-84377393	
You Wo Flavor Food	H1-55	Sichuan Cuisine	50-100RMB	010-84374286	
Hu Guo Si Xiao Chi	H1-58-02	Beijing Local Snacks	20-100RMB	010-84377426	
Pao Pao	H1-44	Hot Pot	30-50RMB	13522404633	

Mcdonald's	H1-42	Fast Food Like Hamburgers And Fries	20-50RMB	010-84374541	
The Pizza Company	H1-43-01	Pizza	40-100RMB	010-84377498	
Bella Vista Restaurant	H1-41	Italian Food Like Spaghetti And Pizza	40-100RMB	010-84377305	
French Teppanyaki	H1-45-02	French Themed Restaurant	50-150RMB	010-84378469	
Na Du	H1-60	Hot-Spicy Pot	50-100RMB	010-84377432	
Classics Foods	H1-50-02	Classical Chinese Food	20-40RMB	010-84378408	
Leisure Restaurant	H1-43-02	Japanese Sushi And Food	50-100RMB	010-84377321	
Long Qi	H1-47	Japanese Food	80-150RMB	010-84370198	
Xiao Diao Li Tang	H1-93-03	Beijing Food	80-150RMB	010-84437260	
Haoshanghao	H1-94-01	Beefsteak	70-150RMB		
Bian Jing	H1-93-02	Southeast Asian Delicacies	80-150RMB	010-84437159	
Xi Le Dou	H1-04	Bakery	20-50RMB	010-84378210	
Sevenana	H1-63-02	Curry Theme Restaurant	30-50RMB	010-84377962	
Shun Kou Liu	H1-52-02	Traditional Chinese Food	20-50RMB	010- 84377442/7443	
Xiangfei Fastfood	H1-58-01	Chinese Fast Food, Famous For Roast Chicken	20-50RMB	010-84378735	

## GENERAL INFORMATION

### Congress Venue

Conveniently located in the heart of the Beijing Olympic Green precinct, the China National Convention Center(CNCC) is right next to the Bird's Nest (China National Stadium), the Water Cube (National Aquatics Center) and National Indoor Stadium. The CNCC complex consists of the convention centre and its exhibition halls, the CNCC Grand Hotel and the InterContinental Hotel.

The CNCC is proud of its stunning architectural design. Its front appearance reminds the viewer of traditional Chinese quins, illustrating rich Chinese history and culture, combining tradition and modernity, and forging a bridge to the future. Sitting in the centre of the Olympic commercial circle between Beijing's fourth and fifth ring roads, the CNCC boasts an enviable location.



Plan of 1<sup>st</sup> floor of CNCC

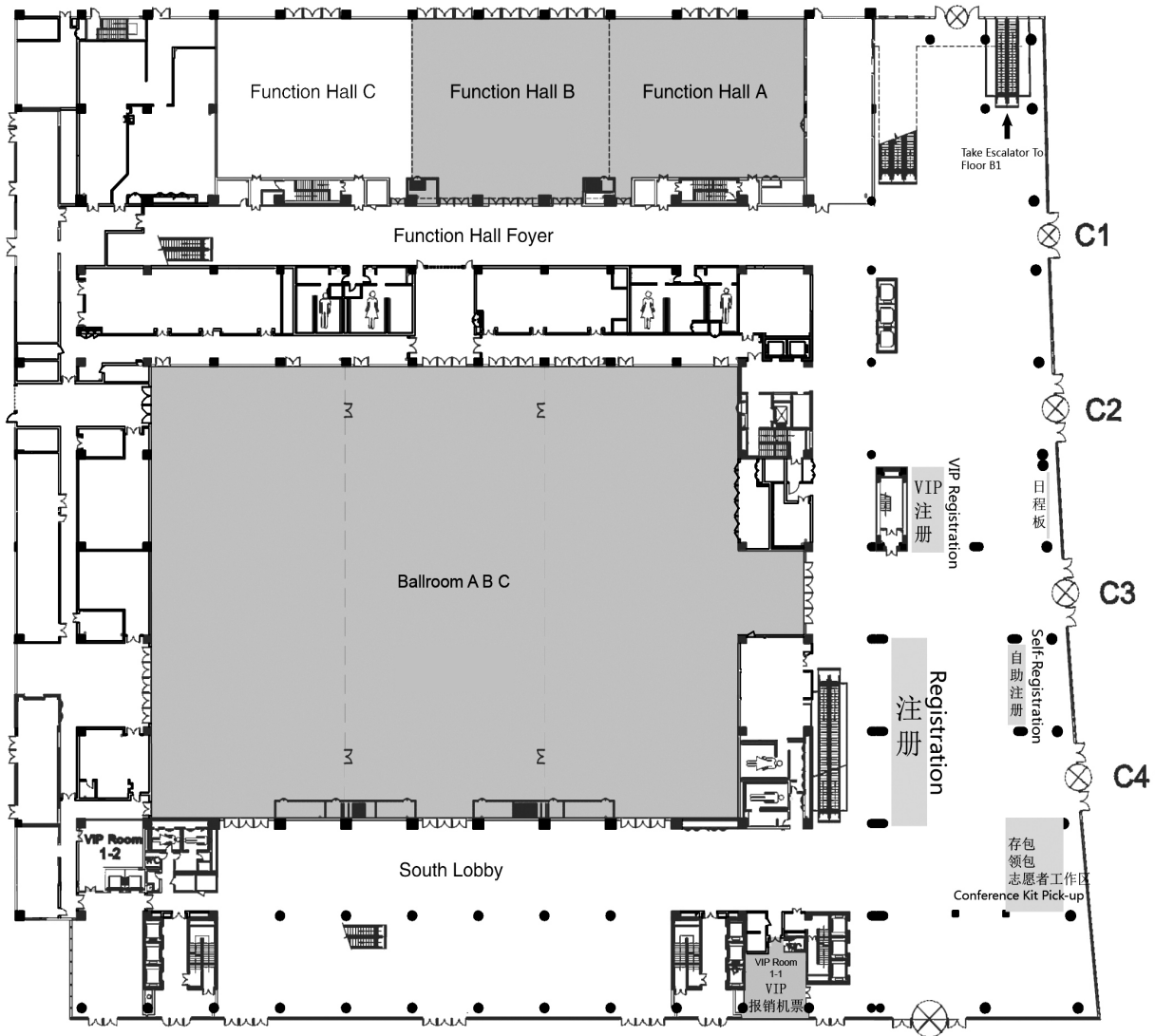

# GENERAL INFORMATION

## Plan of 2<sup>st</sup> floor of CNCC

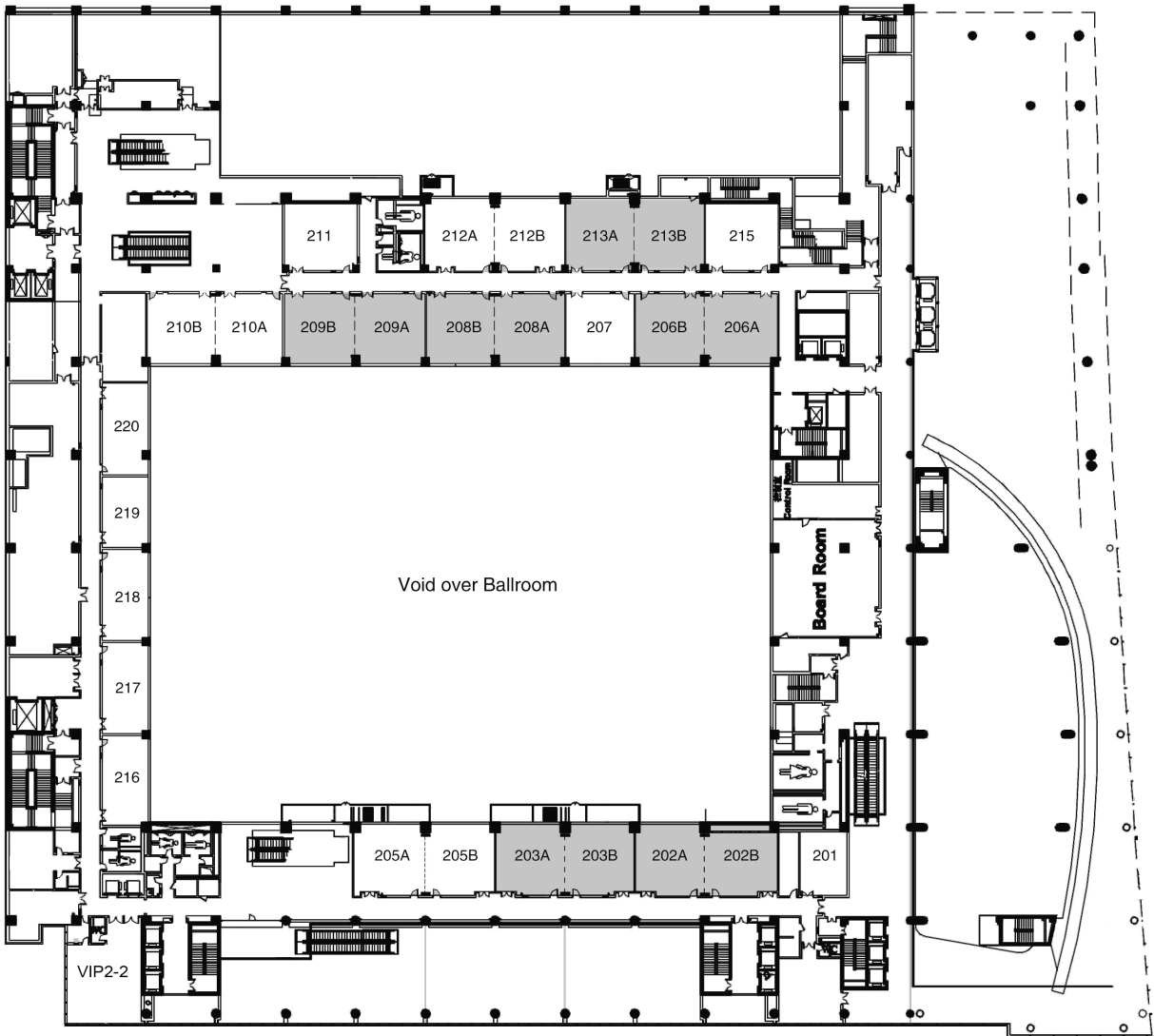

Plan of 3<sup>rd</sup> floor of CNCC

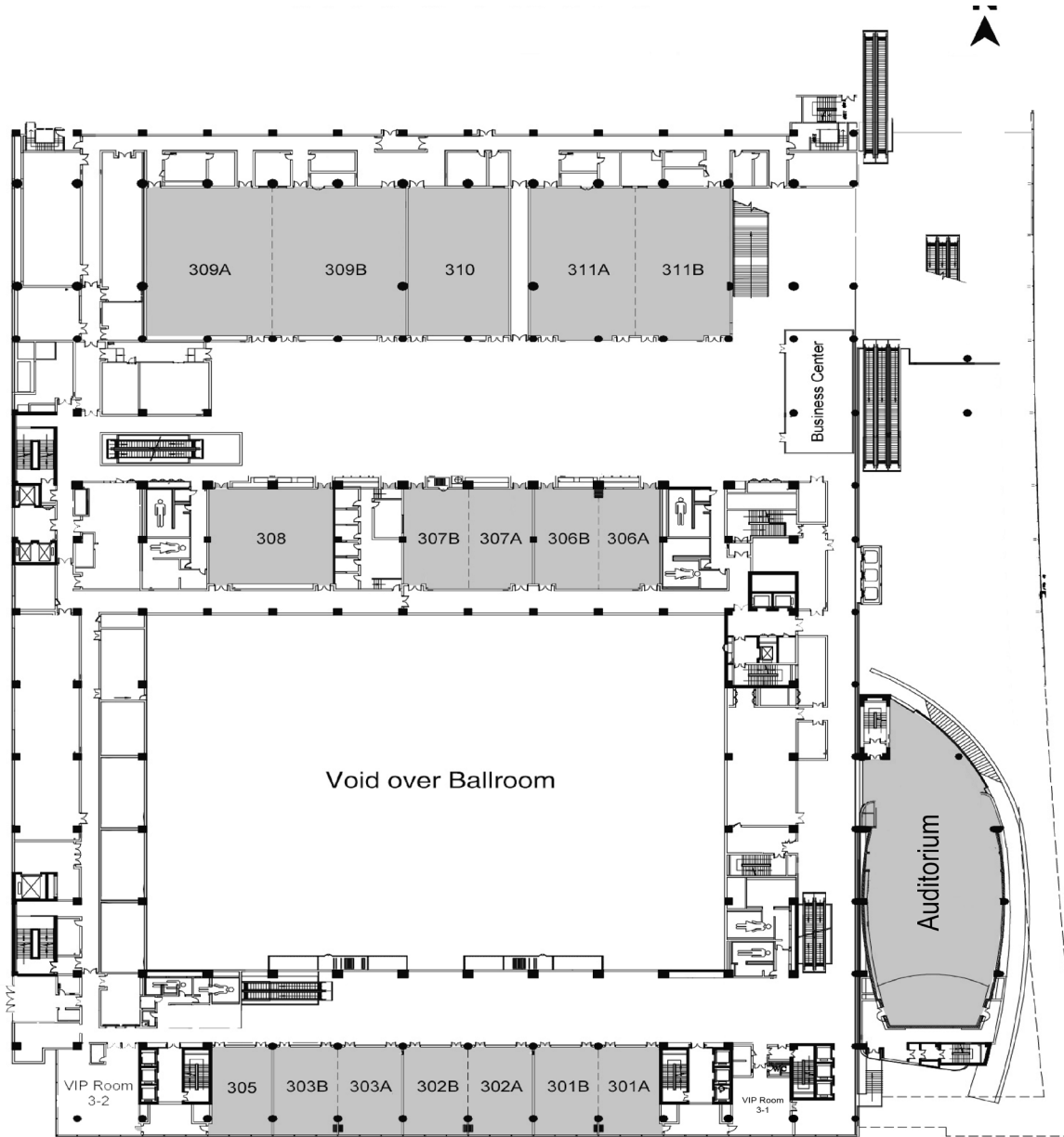

# GENERAL INFORMATION

## Plan of 4<sup>th</sup> floor of CNCC

